

# A New Era of Internet Access Ease and Freedom

- 1** Connect through Any AC Outlet in Your Home
- 2** Easy Setup - No PC Required
- 3** Fast, reliable, and secure

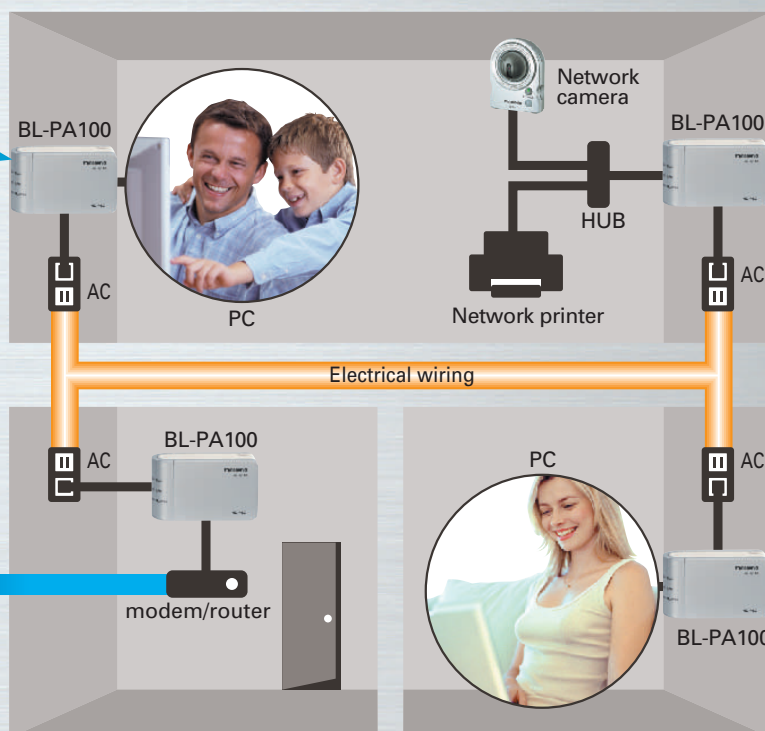

Every AC outlet becomes a network entry point.



# Every AC Outlet in Your Home Becomes an Internet Portal

\*Internet connection requires a contract with a provider, and the appropriate PC and router settings.

Everything you thought about home Internet access is about to change. Have you ever had to run long, unsightly cables from your PC to the modem or router? Or have you thought about installing a wireless LAN but worry about complicated settings and problems with security? Then you will love the new Panasonic HD-PLC Adaptor. With the Panasonic HD-PLC Adaptor,

every AC power outlet in your home becomes a portal for Internet access. Think about that for a moment: You can connect to the Internet from any power outlet in your home. There are no complicated settings to make or cables to connect. And security is outstanding. You enjoy an entirely new level of ease and freedom in going online.

## Connect through any AC outlet in your home

The HD-PLC adaptor makes it possible for your home electrical wiring to serve as a link between your PC and modem. Getting online access is as easy as plugging into a power outlet. You can move your PC and connect to the Internet anywhere there is a power outlet.

### LAN (Ethernet)

- Cables must be laid throughout the house.
- Once the cables are connected, it is difficult to change locations.

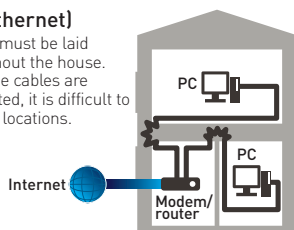

### Wireless LAN

- Security settings are complicated.
- Obstacles such as thick walls can block communications.

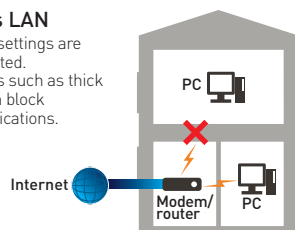

## HD-PLC Ethernet adaptor

- Once it is set up, you can access the Internet from any power outlet.
- Communication is highly safe.
- Communications are comfortably fast.

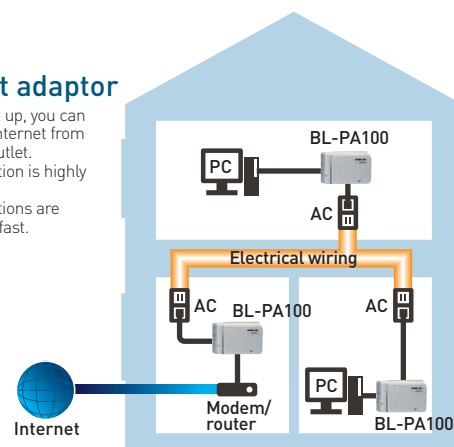

## Easy setup - No PC required

There's no tricky installation or complicated settings. Just take the BL-PA100KT out of the box and plug it into the power outlet. Set up the other equipment on the network, such as routers and PCs, as described in their respective instructions. Adding more HD-PLC adaptors\*1 is easy too, using the following quick 3-step procedure.

\* One HD-PLC adaptor can be set as the master unit, and individual terminal units can be registered. One of the BL-PA100KT units is set as a master unit and the other is set as a terminal unit when they are shipped from the factory.

### Step. 1 Plug it in

Plug the Master and Terminal units into the same power outlet.

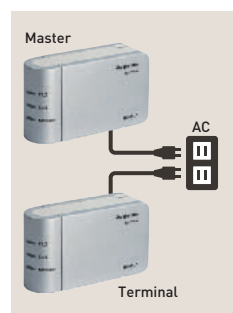

### Step. 2 Push two buttons

Push the Setup button on each unit.

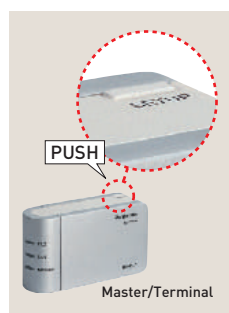

### Step. 3 Watch it light up

An LED lights up to show that setup is complete. You can move the units anywhere you want to go online at home.

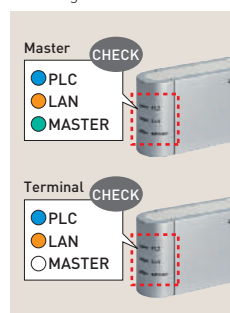

## Fast, reliable, and secure

With speeds of up to **190 Mbps**\*2, advanced error correction, and AES 128-bit encryption, the BL-PA100 provides peace of mind at the speed of light.

\* Connecting this product to a power strip which has a noise filter or surge protector may interfere with the performance of this product. For best results, please connect this product directly to a wall outlet.

\*\* Certain electrical devices such as hair dryers or vacuum cleaners emit electrical noise, and may interfere with the performance of this product.

\*\*\* This product may interfere with short wave radios, lights or lamps which have a dimmer switch or a touch-sensitive on/off feature, or other PLC adaptors which do not use the HD-PLC standard.

## Simple network speed testing

You can confirm the speed of each adaptor's HD-PLC connection by simply pressing a button.

■ Refer to the chart below to determine the network speed.

PLC	<input type="radio"/>	<input type="radio"/>	<input type="radio"/>	<input checked="" type="radio"/>
LAN	<input type="radio"/>	<input type="radio"/>	<input checked="" type="radio"/>	<input checked="" type="radio"/>
MASTER	<input type="radio"/>	<input checked="" type="radio"/>	<input checked="" type="radio"/>	<input checked="" type="radio"/>
Network speed	No link	Good	Better	Best

\* The speed testing function provides a simple indication of the communications speed between the Master and Terminal units. It does not indicate the communications speed between Terminals. Also, the indicated speed is only valid for the moment at which it was measured. It does not imply that the indicated speed will be maintained.

## Specifications

Model No.		BL-PA100A		LAN interface	Interface	10Base-T/100Base-TX Auto MDI/MDI-X
Main unit					Protocol	IPv4 / IPv6 / TCP / UDP
PLC Interface	Standard	HD-PLC		General	Operating temperature	0 °C to 40 °C (32 °F to 104 °F)
	Actual rate	Maximum 70 Mbps (UDP) Maximum 42 Mbps (TCP:When using FTP)			Operating humidity	20 % to 85 %
	Maximum no. of adaptors per network	16 ( including the master)			Dimensions (W x D x H)	121 x 40 x 70 mm (4 3/4 x 1 9/16 x 2 3/4 inches) (Except protrusion)
PLC Interface	Maximum no. of devices connected to each adaptor	8			Weight	240 g (0.53 lb)
					Power supply	Input 100 - 240 V AC
				Consumption	4 W	
HD-PLC standard specification				Error collection		Reed-Solomon encoder/decoder and Convolutional encoder/Viterbi decoder
Frequency band		4 — 28MHz		Encryption		AES 128-bit encryption
Modulation		Wavelet OFDM (16 PAM to 2 PAM)		Communication distance		About 150 m (490 ft) (Varies depending on the electrical environment )
Transmission PHY rate		Maximum 190 Mbps*2				
Access method		CSMA / CA TDMA				

\*1 BL-PA100    \*2 This is the theoretical maximum data transmission speed of the HD-PLC standard. The actual maximum data transmission speed is about 70 Mbps. Results may vary depending on electrical conditions, network environment, and other factors. See the specifications for more information.

Notes • Ethernet is a registered trademark of Fuji Xerox Co., Ltd.  
• Other company names and product names are trademarks or registered trademarks of their respective companies.

**Panasonic**

0.3M0306SPSD-PLCA-LT-CE  
Design and specifications are subject to change without notice.